

A large, light gray decorative cross with ornate, pointed ends, centered behind the text.

EXTEND
Advancing the Kingdom

A light gray silhouette of a city skyline with various building shapes, spanning the width of the page.

CHRIST THE KING PRESBYTERIAN CHURCH

EXTEND
Advancing the Kingdom

CHRIST THE KING PRESBYTERIAN CHURCH

*Your Kingdom come,
your will be done
on earth as it is in heaven.*

MATTHEW 6:10





Imagine the impact this campaign will have for generations to come...for eternity. By extending yourself sacrificially in this campaign, you are affirming that you are passionate about extending Christ's Kingdom in Houston and beyond. *Leo Schuster*

Dear Christ the King family,

What thrilling days lie ahead at Christ the King as we anticipate a permanent church home! At this uniquely important time it is crucial that we keep before us the reason we are taking this course of action.

Of course we all look forward to the many blessings a permanent facility will bring to our own congregation, but the primary reason we are taking this giant step is this:

To powerfully extend Christ's Kingdom

Extending the Kingdom has been the vision for Christ the King from the beginning, and we have always believed that a permanent facility would be vital to fulfilling that vision. We knew this time would come, and now – after ten years of tremendous growth and limited, temporary facilities – is that time. When Jesus launched his public ministry He announced, "The time is fulfilled, and the kingdom of God is at hand; repent and believe in the gospel."

What a privilege the Lord has given us to be His Kingdom-extending agents. What a thrill to see His gospel of grace impact the world through us. Friends, we are building in order to be the most effective Kingdom-advancing engine possible. We will sacrifice greatly now, but what we give today is an investment that will make a difference for generations to come. He is worthy! Let's make the most of the extraordinary opportunity He has given us, and for his glory, may He bless us beyond our wildest expectations!

Yours for the Kingdom,

Leo R. Schuster III
Senior Pastor



EXTEND
Advancing the Kingdom



Advancing the Kingdom in Houston and Beyond!

Advancing the Kingdom in Houston and Beyond!

- **1997** - The Schuster family moves to Houston to start Christ the King.
- **February 2, 1997** – First worship service held at a Galleria-area hotel.
- **March 1997 to August 2000** – Worshipped at West University Elementary.
- **August 27, 2000** – Moved to Houston Community College where our membership has grown from 236 to 1,100.
- **258 babies** have been born to Christ the King members.
- **266 children** are enrolled in 17 Sunday School classes and nurseries.
- Our **student ministry** continues to grow and participates in extending the Kingdom through missions in Houston and throughout the world.
- We have developed **numerous strategic mission partnerships** in Houston, North America, and the world.
- We have sent **12 members to seminary** to train for the ministry, and they are now serving as ministers across the country.
- We have helped start **25 new churches** through the Southwest Church Planting Network.
- We have partnered with members of Christ the King to begin **new churches** in Maine, Oregon and California.
- We support Reformed University Fellowship (RUF) on **nine college campuses** in Texas and the Southwest and have a particular partnership with RUF at Rice University.
- We are **ministering to the nations** right here at home by serving our Liberian brothers and sisters at Christ the King.
- We are currently involved in launching a **new church in Sugar Land** with several Christ the King families.

God has given us an incredible opportunity to reach tens of thousands for Christ in Houston and throughout the world.

Wil VanLoh, Campaign Executive Director



EXTEND
Advancing the Kingdom



Features Include:

- Initial worship space seating 600 people
- Centralized gathering space to foster community
- Age-appropriate nurseries and toddler rooms
- Classrooms for children, students and adults
- Administrative offices
- Playground for children

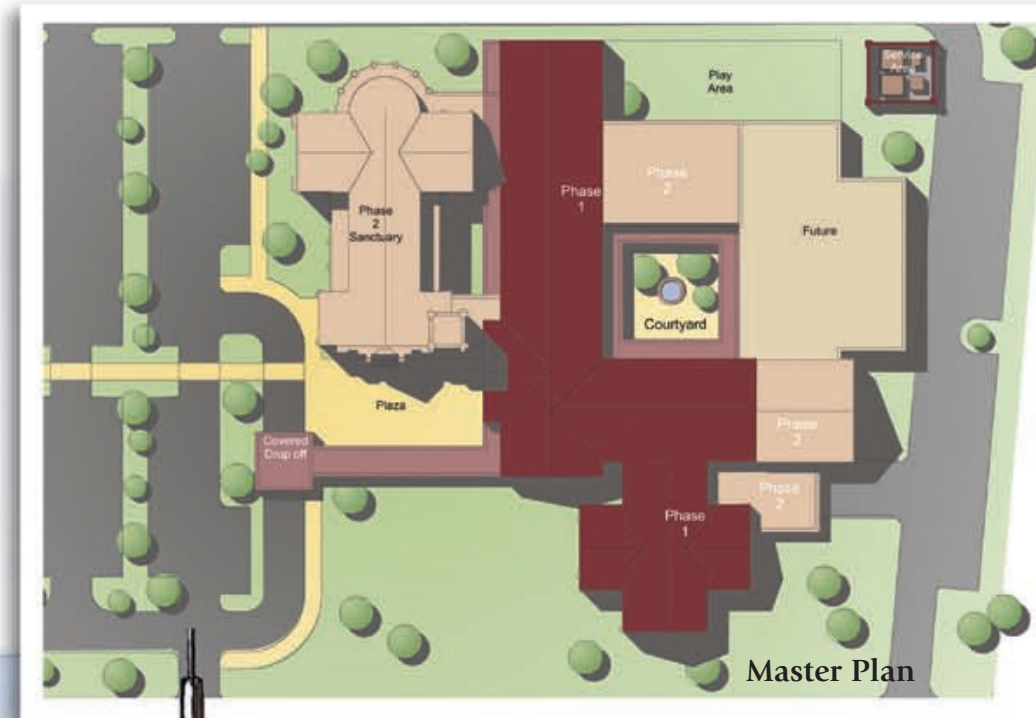

All images: © Bullock Smith & Partners, Inc. 2007 All rights reserved

EXTEND
Advancing the Kingdom



Extending to the Next Generation

"Let the little children come to me and do not hinder them for to such belongs the Kingdom of heaven." Matthew 19:14

Christ the King is privileged to have over 270 children. What a joy it is to minister to and serve these children at our church. A permanent facility will provide classroom space for these children, nurseries for babies, and space for our children's worship called k.i.C.k.s., "kids in Christ's kingdom."

A permanent facility will enable us to provide a safe, child-friendly environment for our children to build relationships and grow in their faith. It will also enable us to provide child care for events such as Women's Bible Study, Vacation Bible School, Community Groups and more!

By the year 2011, over 80 children at our church will be teenagers. How exciting to know that we have a chance to make a Kingdom impact in their lives! A permanent facility will provide a place for them to bring their friends to Sunday school, youth group and worship on Sundays and throughout the week.





You make a living by what you get, but you make a life by what you give. *Winston Churchill*

Extending Ourselves in Order to Extend!

Our goal is to raise \$12 million to complete the construction debt free. This will require sacrificial participation from each one of us. We are asking everyone in the Christ the King family to make such a gift over and above their regular tithe to the operating budget of the church.

You may EXTEND your gifts over a three year period of time, which means you may make a pledge today and fulfill it by the end of 2010. For those interested in beginning your gifts to the campaign in this calendar year, you will enjoy the benefit of four tax years.

What an exciting, memorable and faith-building time to be a member of Christ the King! **God has entrusted us with the extraordinary privilege of establishing a visible Kingdom presence** in the city of Houston. From this ministry platform, by God's grace and for his glory, we will launch ministries of grace and compassion throughout the world that will bring refreshment and renewal.

The EXTEND campaign is first and foremost a spiritual process. Before you determine what you will give, earnestly seek the Lord in prayer and thoughtful reflection (a devotional guide has been developed to assist you in this). May the Lord richly bless you as you draw near to him.

We have a wonderfully unique opportunity before us now, motivated by God's incomparable grace, to give joyfully, generously, and sacrificially to something that will far outlive us...to invest in a facility that will not only make a substantial difference to our current congregation, but also to future generations. He is worthy!

"Worthy is the Lamb who was slain to receive power and wealth and wisdom and strength and honor and glory and praise!" Revelation 5:12



EXTEND
Advancing the Kingdom



Special Thanks to the EXTEND Steering Committee

Jennifer and Wil VanLoh, *Executive Directors*

Ryan Dolibois, *Campaign Manager*

Meredith and Carter Crow

Dorothy and Ronny Cuenod

Carol and Sonny DeShong

Sarah Diamantopoulos

Carolyn Durkee

Alison and Jason Fleming

Laura and Denman Heard

Marcille and Bonham Magness

Jane and Rick McCord

Elise and Jonathan Mueller

Sara and Bret Oliver

Lance Orton

Christi and Ari Pramudji

Cecille and George Shannon

Michelle and Alan Smith

Jenny and Blake Webster

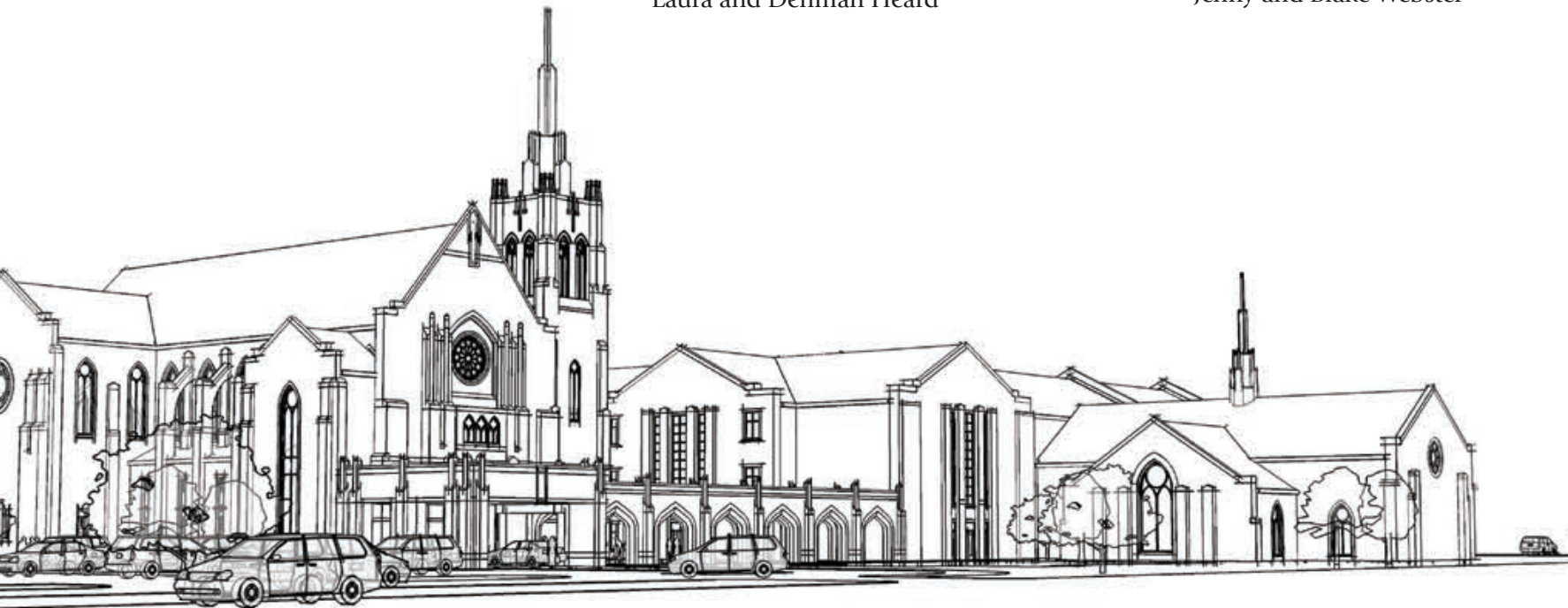

** Conceptual design of future master plan*

EXTEND

Advancing the Kingdom





EXTEND
Advancing the Kingdom



CHRIST THE KING PRESBYTERIAN CHURCH

777 Post Oak Blvd., Suite 340 • Houston, TX 77056 • 713.892.5464